

Diaphragm Check Valve

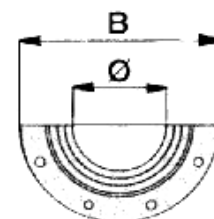

Features

1. Check Diaphragm valve acc. EN1074 - 3 : 2000
2. Made by Ductile Cast Iron EN-GJS_500/7
3. Flanges ends according EN 1092-2.
4. EPDM seal.
5. Silent closing.
6. Stem made by brass + Nickel until DN-100, DN-125 + more cast iron EN-GJS_500/7 + Nickel plated.
7. Installed in vertical or horizontal position.
8. Max. working pressure 25 bar.
9. Working temperature -10 °C + 100 °C.
10. Not suitable for use in steam.

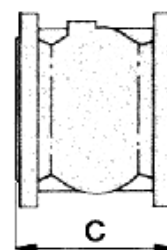
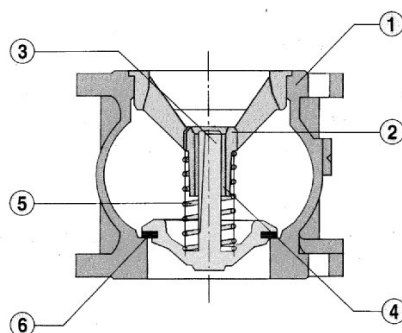

| Nº | Specification | Material | Surface Treatment |
|----|---------------|-----------------|-------------------|
| 1 | Body | EN-GJS 500/7 | Epoxy painted |
| 2 | Guide | EN-GJS 500/7 | Nickel Plated |
| 3 | Guiding stem | EN-GJS 500/7 | Nickel Plated |
| 4 | Bushing | Brass | ----- |
| 5 | Spring | Stainless steel | 1.44.07 |
| 6 | Seal | EPDM | ----- |

GENERAL DIMENSIONS

| Inchs | Size | PN | Ø | Dimensions (mm) | | Weight ,kg |
|--------|-------|-------|-----|-----------------|-----|------------|
| | | | | B | C | |
| 2" | DN50 | 16 | 51 | 165 | 100 | 5.65 |
| 2 1/2" | DN65 | 16 | 63 | 185 | 120 | 7.85 |
| 3" | DN80 | 16 | 80 | 200 | 140 | 10.05 |
| 4" | DN100 | 16 | 100 | 220 | 170 | 13.25 |
| 5" | DN125 | 16 | 125 | 250 | 200 | 21.30 |
| 6" | DN150 | 16 | 150 | 285 | 230 | 29.15 |
| 8" | DN200 | 10/16 | 200 | 340 | 300 | 48.15 |
| 10" | DN250 | 10/16 | 250 | 405 | 370 | 82.00 |

HEAD LOSSES DIAGRAM

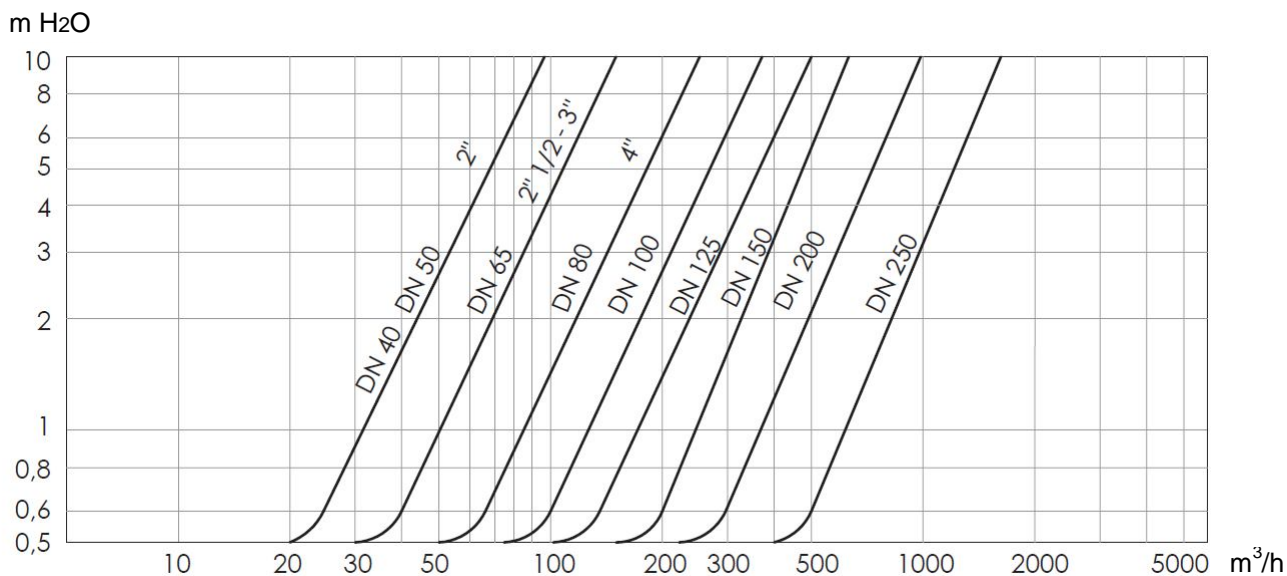

| D | Inch | 2" | 2 1/2" | 3" | 4" | 5" | 6" | 8" | 10" |
|----|-------------------|----|--------|-----|-----|-----|-----|-----|------|
| Kv | m ³ /h | 95 | 140 | 250 | 355 | 505 | 640 | 995 | 1750 |

MINIMUM OPENING PRESSURE

| <i>FLOW</i> | <i>Aplication</i> | <i>Pressure</i> | DN 50 | DN 65 | DN 80 | DN 100 | DN 125 | DN 150 | DN 200 | DN 250 |
|--------------------|--------------------------|------------------------|--------------|--------------|--------------|---------------|---------------|---------------|---------------|---------------|
| ↑ | Std. | mbar | 62.5 | 63.5 | 58 | 61 | 56 | 51.5 | 63 | 68 |
| ↓ | Std. | mbar | 37.5 | 31 | 28 | 32 | 18 | 17 | 22 | 21 |
| → | Std. | mbar | 50 | 49 | 45 | 48 | 38.5 | 35.5 | 43 | 45 |
| ↑ | <i>Without Spring</i> | mbar | 12.5 | 17 | 16 | 15 | 21 | 19 | 21 | 25 |

PRESSURE-TEMPERATURE RATING

